

ONE TOUCH FITTINGS

Stainless Steel - Series WM5

Cat No WM5 - 01 - 01 - A

ONE TOUCH FITTINGS (STAINLESS STEEL) - Ø4 to 16mm

Features

- Attractive design
- Compact size
- Threaded nipples of Male Elbow fittings enable to turn by 360°
- Full area of the inner bore of the tubing is available for flow of fluid
- Stainless steel design ensures superior clamping by bubble tight sealing of various tubes
- Suitable for different materials of tubing (Nylon (Polyamide), Soft Nylon, Polyurethane, Polyethylene)
- Easy and quick push-in connection of tube / easy removal of tube by simple pressing of collet cap
- Maintenance free and long life
- Short parallel thread connection
- Male thread seal - BSP - PTFE seal
- No loosening of tube due to vibration - positive gripping by collet

Applications

Stainless steel fittings can be effectively used in all air, water and steam applications
Some of the air, water and steam applications include

- Movement applications like air cylinders (all types), robotics, conveyor systems
- Directional control valves, solenoid valves and other valves
- Air preparation units like filter, regulator and lubricators
- Applicable to use with all food industry and beverages industries
- High temperature industries like power plants, oil & gas and other applications
- High corrosion resistant material allows to use with chemical industries and medical equipments
- Any systems requiring transfer of compressed air, water, steam through lines and machineries of all kinds

Technical Specifications

Medium	Air, Water, Steam #			
Maximum operating pressure	10 bar			
Ambient / Medium temperature for Viton	-5° to +150° C			
Ambient / Medium temperature for NBR	-10° to +60° C			
Threaded connection	Male: G - Parallel thread, Female: G - Parallel thread			
Materials of construction	SS 304, SS 316, FKM (Viton), NBR (on request), PTFE			
Applicable tube material	PA6 (Nylon), Soft Nylon, Polyurethane, Polyethylene			
Applicable tube size (OD)	Ø4, 6, 8, 10, 12 and 16 mm			
Recommended tolerance for tube OD	± 0.1 mm			
Recommended minimum wall thickness of tubes	Nylon		PU	
	Tube OD (mm)	Thickness (mm)	Tube OD (mm)	Thickness (mm)
	Ø4	1	Ø4	1
	Ø6		Ø6	1
	Ø8		Ø8	1.5 / 1.25
	Ø10		Ø10	1.5
	Ø12		Ø12	2
	Ø16		Ø16	2.5

- for other fluids, contact **JANATICS**

ONE TOUCH FITTINGS

Stainless Steel - Series WM5

Cat No WM5 - 01 - 01 - A

Straight Union

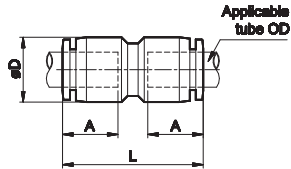

Applicable Tube OD	ØD	L	A	Ordering No
4	10.5	26.5	12.5	WM5100404DB
6	12	29	14	WM5100606DB
8	14.5	33.5	16	WM5100808DB
10	18	35	17	WM5101010DB
12	20	41	20	WM5101212DB
16	24	42.5	20.5	WM5101616DB

Different Dia. Straight Union

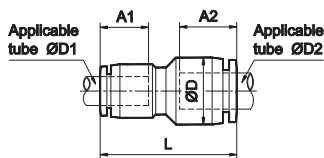

Applicable Tube OD		ØD	L	A1	A2	Ordering No
ØD1	ØD2					
4	6	12	28	12.5	14	WM5140406DB
6	8	15	31	14	16	WM5140608DB
8	10	18	34	16	17	WM5140810DB
10	12	20	38	17	20	WM5141012DB
12	16	24	42	20	20.5	WM5141216DB

Union Tee

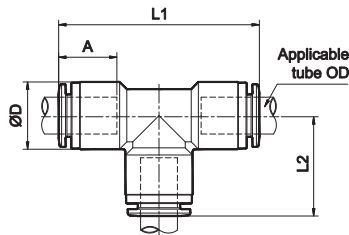

Applicable Tube OD	ØD	L1	L2	A	Ordering No
4	10.5	36	18	12.5	WM530040404DB
6	12	40	20	14	WM530060606DB
8	15	44	21.5	16	WM530080808DB
10	18	49	24.5	17	WM530101010DB
12	20	54.5	27	20	WM530121212DB
16	24	58.5	29	20.5	WM530161616DB

Male Connector

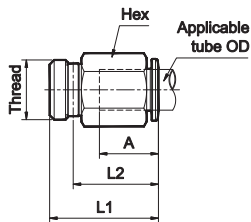

Applicable Tube OD	Thread	Hex	L1	L2	A	Ordering No
4	G1/8	10	17.5	13	12.5	WM5110460SD01B
	G1/4	14	19.5	14	12.5	WM5110461SD01B
6	G1/8	12	20	15.5	14	WM5110660SD01B
	G1/4	14	21	16	14	WM5110661SD01B
	G3/8	17	23	17	14	WM5110662SD01B
8	G1/8	14	24	19	16	WM5110860SD01B
	G1/4	14	24	19	16	WM5110861SD01B
	G3/8	17	23	17	16	WM5110862SD01B
10	G1/8	17	25	20	17	WM5111060SD01B
	G1/4	17	26	21	17	WM5111061SD01B
	G3/8	17	25	19	17	WM5111062SD01B
	G1/2	22	25	18	17	WM5111063SD01B
12	G1/4	19	29	24	20	WM5111261SD01B
	G3/8	19	29.5	23.5	20	WM5111262SD01B
	G1/2	22	28.5	22	20	WM5111263SD01B
16	G3/8	24	31	25	20.5	WM5111662SD01B
	G1/2	24	32	25	20.5	WM5111663SD01B

A, A1, A2 - Tube insertion length

ONE TOUCH FITTINGS

Stainless Steel - Series WM5

Cat No WM5 - 01 - 01 - A

Female Connector

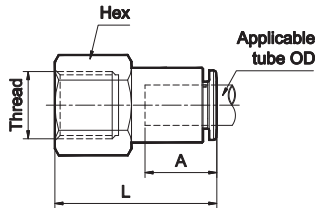

Applicable Tube OD	Thread	Hex	L	A	Ordering No
4	G1/8	12	24.5	12.5	WM5120460D01B
	G1/4	17	29	12.5	WM5120461D01B
6	G1/8	12	25.5	14	WM5120660D01B
	G1/4	17	29.5	14	WM5120661D01B
	G3/8	19	32	14	WM5120662D01B
8	G1/8	14	27	16	WM5120860D01B
	G1/4	17	32	16	WM5120861D01B
	G3/8	19	33	16	WM5120862D01B
10	G1/4	17	32.5	17	WM5121061D01B
	G3/8	19	34.5	17	WM5121062D01B
	G1/2	24	34.5	17	WM5121063D01B
12	G1/4	19	35.5	20	WM5121261D01B
	G3/8	19	37.5	20	WM5121262D01B
	G1/2	24	41	20	WM5121263D01B
16	G3/8	24	38	20.5	WM5121662D01B
	G1/2	24	42.5	20.5	WM5121663D01B

Male Elbow

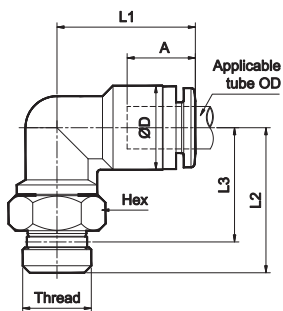

Applicable Tube OD	Thread	Hex	ØD	L1	L2	L3	A	Ordering No
4	G1/8	12	10	18	20	15	12.5	WM5210460SD01B
	G1/4	14	10	18	21	15.5	12.5	WM5210461SD01B
6	G1/8	12	12	21	21	16	14	WM5210660SD01B
	G1/4	14	12	21	21.5	16	14	WM5210661SD01B
	G3/8	17	12	21	22.5	16.5	14	WM5210662SD01B
8	G1/8	12	14.5	24	22.5	18	16	WM5210860SD01B
	G1/4	14	14.5	24	23.5	18	16	WM5210861SD01B
	G3/8	17	14.5	24	24	18	16	WM5210862SD01B
10	G1/8	14	17.5	27	24	19	17	WM5211060SD01B
	G1/4	14	17.5	27	25	19.5	17	WM5211061SD01B
	G3/8	17	17.5	27	26	20	17	WM5211062SD01B
	G1/2	22	17.5	27	28	21	17	WM5211063SD01B
12	G1/4	17	20	30	26.5	21	20	WM5211261SD01B
	G3/8	19	20	30	27.5	21	20	WM5211262SD01B
	G1/2	22	20	30	30	22.5	20	WM5211263SD01B
16	G3/8	19	24	34	30	24	20.5	WM5211662SD01B
	G1/2	22	24	34	32	25	20.5	WM5211663SD01B

How to order

While ordering fittings, mention the Ordering number given in the corresponding tables, and for tubes, mention the ordering number with required length in metres.